

SYMBOLS LEGEND	
	- DEMOLITION NOTE
	- ELEVATION REFERENCE GRID
	- ELEVATION BENCHMARK
	- WALL TYPE
	- ELEVATION KEY

- GENERAL NOTES**
1. CONTRACTOR SHALL VERIFY ALL CONDITIONS & DIMENSIONS IN THE FIELD PRIOR TO COMMENCEMENT OF WORK.
 2. AREAS OF DEMOLITION ARE DENOTED BY DASHED LINES UNLESS OTHERWISE DIRECTED.
 3. THE OWNER HAS FIRST REFUSAL RIGHTS ON ALL ITEMS & MATERIALS REMOVED. ALL ITEMS & MATERIALS NOT RETAINED BY THE OWNER SHALL BE DISPOSED OF PROPERLY BY THE CONTRACTOR.
 4. ALL AREAS OF DEMOLITION SHALL BE PATCHED AND REPAIRED AS REQUIRED FOR NEW CONSTRUCTION & FINISHES.
 5. COORDINATE DEMOLITION WITH PROPOSED NEW CONSTRUCTION.
 6. CONTRACTOR TO VERIFY RATING OF EXISTING DOORS/FRAMES & REPLACE IN KIND.
 7. REMOVE EXISTING FINISHES WHERE NEW FINISHES ARE SCHEDULED. PREPARE EXISTING SURFACES ACCORDINGLY.
 8. THE CONTRACTOR SHALL BE RESPONSIBLE FOR THE MAINTENANCE OF ALL ACCESS ROADS AND PARKING AREAS.
 9. THE CONTRACTORS ARE RESPONSIBLE FOR INSPECTING THE JOBSITE PRIOR TO SUBMITTING THE BID. ALL VISIBLE ASPECTS OF THE EXISTING CONDITIONS WILL BE CONSIDERED TO BE INCLUDED WITHIN THE BASE BID AND NOT CONSIDERED AS EXTRA WORK.
 10. THE SELECTIVE DEMOLITION AS SHOWN ON THE DRAWINGS ARE DIAGRAMMATIC, AND IN NO WAY ATTEMPT TO SHOW ALL EXISTING FIXTURES, CONNECTIONS AND FITTINGS AND OTHER MISCELLANEOUS ITEMS. THE COMPLETE REMOVAL OF ALL EXISTING OR ABANDONED MECHANICAL, ELECTRICAL AND PLUMBING SYSTEMS WILL BE REQUIRED BY THE CONTRACTOR AND DISPOSED OFF SITE ACCORDING TO ALL LOCAL CODES AND AUTHORITY.
 11. THE CONTRACTOR SHALL BE RESPONSIBLE TO CONTROL THE CONTAINMENT OF DUST AND DEBRIS DURING THE DEMOLITION PERIOD.
 12. THE CONTRACTOR SHALL BE RESPONSIBLE TO TAKE ALL NECESSARY PRECAUTIONS TO MAINTAIN THE STRUCTURAL INTEGRITY OF THE BUILDING AT ALL TIMES AND TO PROVIDE AND BE RESPONSIBLE FOR SHORING AND BRACING REQUIRED THROUGHOUT THE CONSTRUCTION PERIOD. PRIOR TO BEGINNING DEMOLITION, THE CONTRACTOR SHALL SUBMIT TO THE OWNER A DEMOLITION PLAN OUTLINING THE DESIRED PLACEMENT OF DUMPSTERS, DUST AND DEBRIS CONTROL MEASURES AND SCHEDULE OF ACTIVITIES.
 13. THE WORK DESCRIBED WITHIN THE CONTRACT DOCUMENTS SHALL BE DONE IN ACCORDANCE WITH ALL APPLICABLE CODES AND ALL MATERIALS SHALL BE INSTALLED ACCORDING TO MANUFACTURERS SPECIFICATIONS AND TO WARRANTY REQUIREMENTS.
 14. REMOVE ALL ITEMS SCHEDULED TO BE DEMOLISHED AND DISPOSE OF PROPERLY OFF SITE.
 15. THE CONTRACTOR SHALL BE RESPONSIBLE TO PROVIDE SECURE AND WEATHER PROOF ENCLOSURES DURING WINDOW REMOVAL AND REPLACEMENT OPERATIONS.

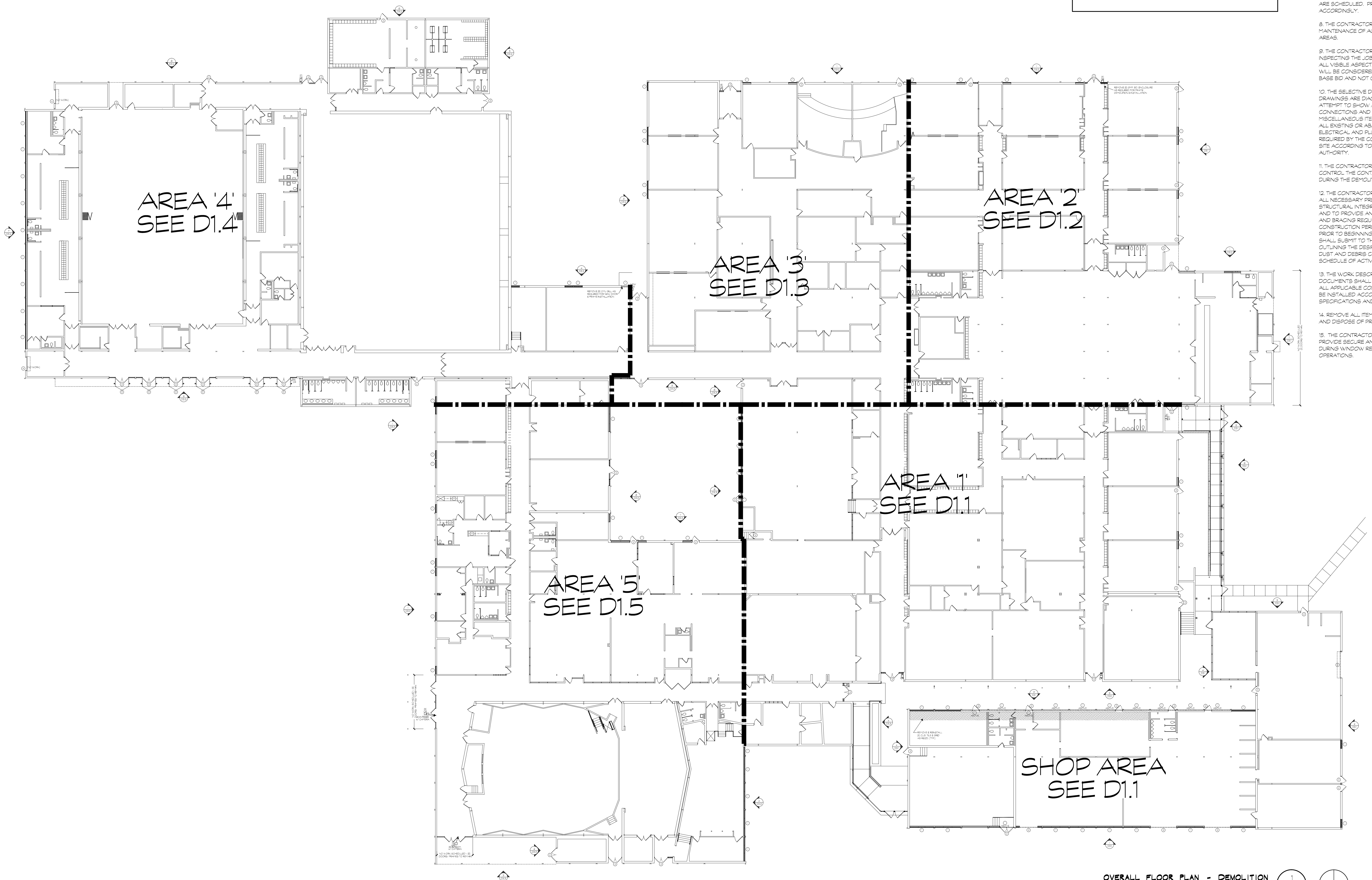

OVERALL FLOOR PLAN - DEMOLITION
NO SCALE

DRAWINGS INTENT TO INDICATE GENERAL ARRANGEMENT, DESIGN AND DIMENSIONS. DIMENSIONS SHALL NOT BE SCALED FOR CONSTRUCTION. SHOP DRAWINGS TO BE SUBMITTED BY CONTRACTOR FOR VERIFICATION OF DIMENSIONS.

DESIGN THAT THESE DOCUMENTS WERE PREPARED OR APPROVED BY ME OR UNDER MY SUPERVISION AND I AM A LICENSED ARCHITECT UNDER THE LAWS OF THE STATE OF MARYLAND.
LICENSE NO. 8075
EXPIRES DATE 09/20/14

BUSHEY FEIGHT MORIN ARCHITECTS INC.
473 North Potomac Street - Hagerstown, Md 21740
301-733-5600 Fax 301-733-5612
Email: BFM@BFMArchitects.com
© copyright 2014, Bushey Feight Morin Architects, Inc.

BFM
BFM# 11071
PSC# 21001.14SR
WCP# BOONSBORO HIGH SCHOOL
WINDOW & DOOR REPLACEMENT

OVERALL FLP
PLAN DEMO
D1.0
1 OF SHEETS
DATE: 1/28/14