

- DEMOLITION NOTES**
- 1 REMOVE (E) WINDOW FRAME, GLAZING & ASSOCIATED WINDOW TREATMENTS - PATCH & REPAIR ADJACENT WALLS AS REQUIRED.
 - 2 REMOVE (E) DOOR & FRAME - PATCH & REPAIR ADJACENT WALLS & FLOOR AS REQUIRED.
 - 3 REMOVE (E) DOOR & HARDWARE, PATCH & REPAIR (E) ADJACENT HOLLOW METAL FRAMES AS REQUIRED.
 - 4 REMOVE (E) HOLLOW METAL FRAME, PATCH & REPAIR (E) MASONRY AS REQUIRED.
 - 5 REMOVE (E) STL. ANGLE OVER-HEAD DOOR STOP, GRIND FLUSH W/ ADJACENT STL. & PAINT EXPOSED EDGE.
- ABATEMENT NOTES**
- 1 REMOVE (E) LAMINATED PORCELAIN PANEL & FRAME. REFER TO ABATEMENT SPECIFICATIONS. PATCH & REPAIR (E) MASONRY AS REQUIRED.

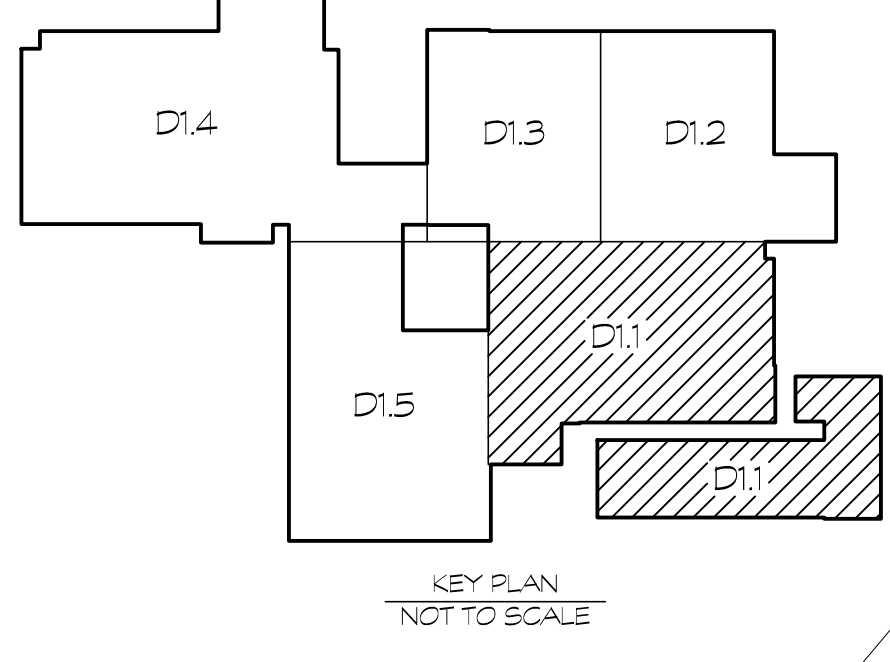

AREA 1' FLOOR PLAN - DEMOLITION
 1/8" = 1'-0"
 1/8" = 1'-0"
 SCALE: 0 5 10 15 20 FEET
 NORTH

DRAWINGS INTENT IS TO INDICATE GENERAL ARRANGEMENT, DESIGN AND DIMENSIONS. IT SHALL NOT BE SCALED FOR CONSTRUCTION. SEE SPECIFICATIONS FOR DIMENSIONS AND ABATEMENT REQUIREMENTS.

I CERTIFY THAT THESE DOCUMENTS WERE PREPARED OR SUPERVISED BY ME OR UNDER MY CLOSE PERSONAL SUPERVISION AND THAT I AM A LICENSED ARCHITECT UNDER THE LAWS OF THE STATE OF MARYLAND.

LICENSE NO. 8078
 EXPIRES DATE 09/01/16

BUSHEY FEIGHT MORIN ARCHITECTS INC.
 473 North Potomac Street, Hagerstown, MD 21740
 301-733-5600 Fax 301-733-5612
 Email: BFM@BFMArchitects.com

© copyright 2014, Bushey Feight Morin Architects, Inc.

WCPSS - BOONSBORO HIGH SCHOOL
WINDOW & DOOR REPLACEMENT

BFM
 BFM# 11071
 PSC# 2100114SR

AREA 1' FLR. PLAN DEMO
D1.1
 1 OF SHEETS
 DATE: 1/28/14