

- DEMOLITION NOTES**
- REMOVE (E) WINDOW FRAME, GLAZING & ASSOCIATED WINDOW TREATMENTS - PATCH & REPAIR ADJACENT WALLS AS REQUIRED.
 - REMOVE (E) DOOR & FRAME - PATCH & REPAIR ADJACENT WALLS & FLOOR AS REQUIRED.
 - REMOVE (E) DOOR & HARDWARE, PATCH & REPAIR (E) ADJACENT HOLLOW METAL FRAMES AS REQUIRED.
 - REMOVE (E) HOLLOW METAL FRAME, PATCH & REPAIR (E) MASONRY AS REQUIRED.
 - REMOVE (E) STL ANGLE OVER-HEAD DOOR STOP, GRIND FLUSH W/ ADJACENT STL & PAINT EXPOSED EDGE.
- ABATEMENT NOTES**
- REMOVE (E) LAMINATED/PORCELAIN PANEL & FRAME. REFER TO ABATEMENT SPECIFICATIONS. PATCH & REPAIR (E) MASONRY AS REQUIRED.

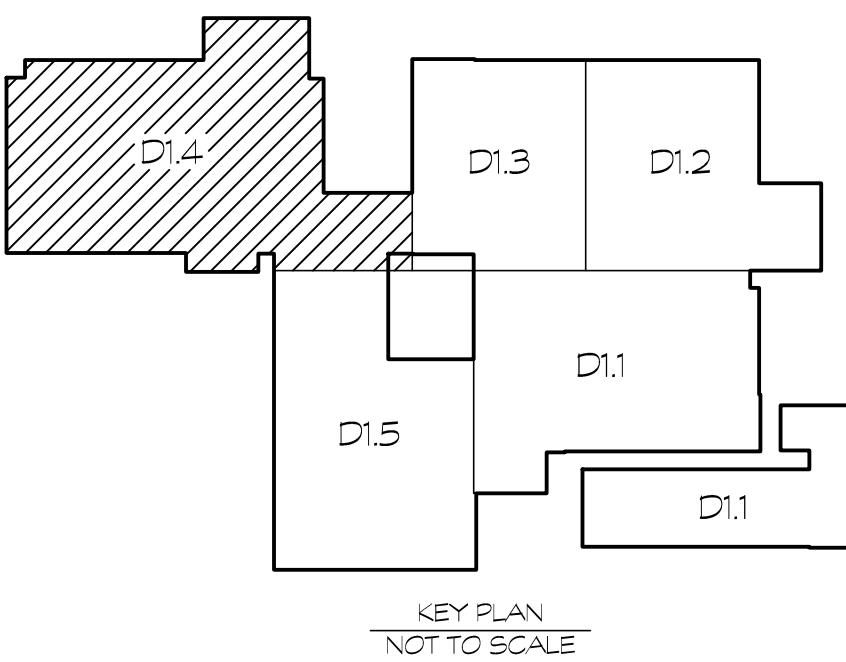

REMOVE (E) CMU SILL AS REQUIRED FOR NEW DOOR & FRAME INSTALLATION

AREA '4' FLOOR PLAN - DEMOLITION

1/8" = 1'-0"
1/8" = 1'-0"
SCALE

1 OF SHEETS
DATE: 1/28/14

DRAWINGS INTENT IS TO INDICATE GENERAL ARRANGEMENT, DESIGN AND DIMENSIONS. IT SHALL NOT BE SCALED FOR CONSTRUCTION OR FOR ANY OTHER PURPOSE. CONSULT THE ARCHITECT FOR ANY QUESTIONS OR FOR A MORE DETAILED EXPLANATION OF DIMENSIONS.

DESIGNERS WHOSE DOCUMENTS WERE REVIEWED OR APPROVED BY THE ARCHITECT UNDER THE LAWS OF THE STATE OF MARYLAND:
LICENSE NO. 8075
EXPIRES DATE 09/2016

BUSHEY FEIGHT MORIN ARCHITECTS INC.
473 North Potomac Street, Hagerstown, Md 21740
301-733-5600 Fax 301-733-5612
Email: BFM@BFMArchitects.com

© copyright 2014, Bushey Feight Morin Architects, Inc.

BFM

BFM# 11071
WCP# 2100114SR
PSC# 2100114SR

WCP# BOONSBORO HIGH SCHOOL
WINDOW & DOOR REPLACEMENT

AREA '4' FLR. PLAN DEMO
D1.4
1 OF SHEETS
DATE: 1/28/14