

1 ELECTRICAL - ALLIED HEALTH FLOOR PLAN - DEMOLITION
SCALE: 1/8" = 1'-0"

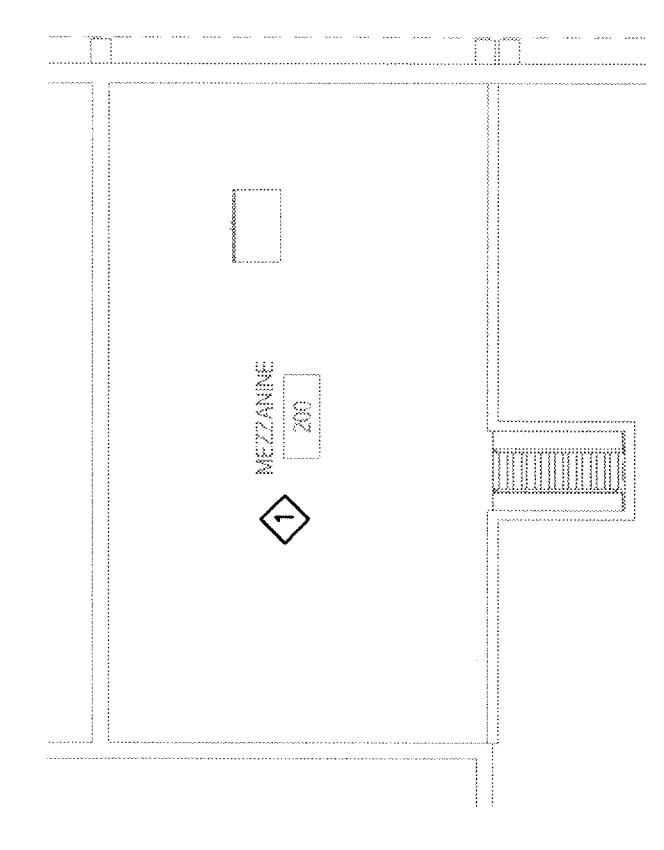

2 ELECTRICAL - ALLIED HEALTH MEZZANINE PLAN - DEMOLITION
SCALE: 1/8" = 1'-0"

KEY NOTES:
 ◊ REMOVE EXISTING LIGHTING
 IN NOTED ROOM.

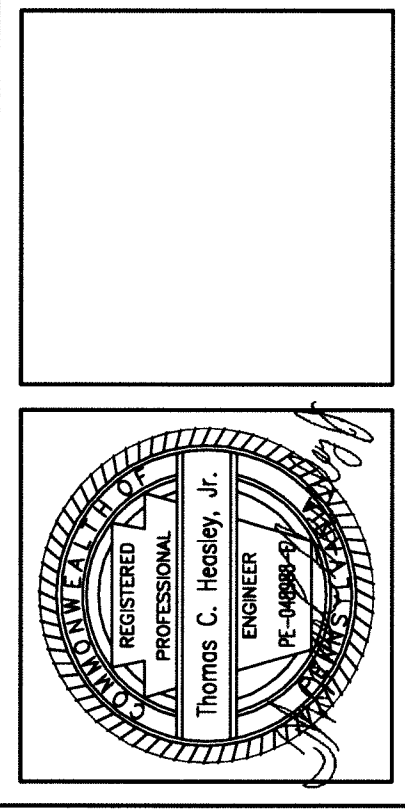

ALL REPORTS, PLANS, SPECIFICATIONS AND COMPLETES RELYING ON THIS PROJECT ARE THE PROPERTY OF CRABTREE ROHRBAUGH & ASSOCIATES, INC. AND ARE NOT TO BE REPRODUCED OR TRANSMITTED IN ANY FORM OR BY ANY MEANS, ELECTRONIC OR MECHANICAL, INCLUDING PHOTOCOPYING, RECORDING, OR BY ANY INFORMATION STORAGE AND RETRIEVAL SYSTEM. PERMISSION TO REPRODUCE THIS DOCUMENT OR ANY PART THEREOF MUST BE OBTAINED FROM CRABTREE ROHRBAUGH & ASSOCIATES, INC. 2014

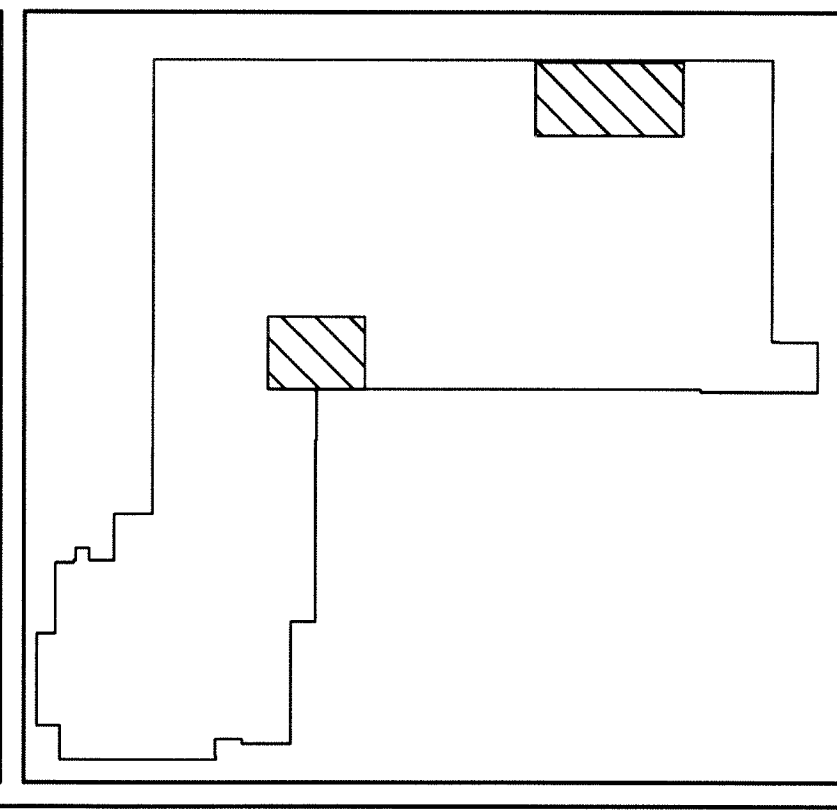

NO.	DATE	DESCRIPTION OF CHANGES

CRABTREE ROHRBAUGH & ASSOCIATES - ARCHITECTS
 401 EAST WINDING HILL ROAD
 MECHANICSBURG PA 17055
 250 WEST MAIN STREET, SUITE 200
 CHARLOTTESVILLE VA 22902
 434-975-7262 FAX 434-975-7263
 434-975-7262 FAX 434-975-7263
 www.cra-architects.com

CR

Pyramid
 ENGINEERING, ARCHITECTURE & INTERIORS, P.C.
 300 Fifth Ave, P.O. Box 5333
 Allentown, PA, 18102
 610-465-9910

ELECTRICAL - FLOOR
 PLANS - DEMOLITION

PROJECT
 2776

E1.2

DATE: 4/22/2014

FRANKLINTON COUNTY CAREER AND ALLIED HEALTH CLASSROOMS
 FRANKLIN COUNTY TECHNICAL SCHOOL AUTHORITY
 2463 LOOP ROAD CHAMBERSBURG, PENNSYLVANIA 17202