

**1 Center Bay Arch Reconstruction**  
Scale: 3/4" = 1'-0"

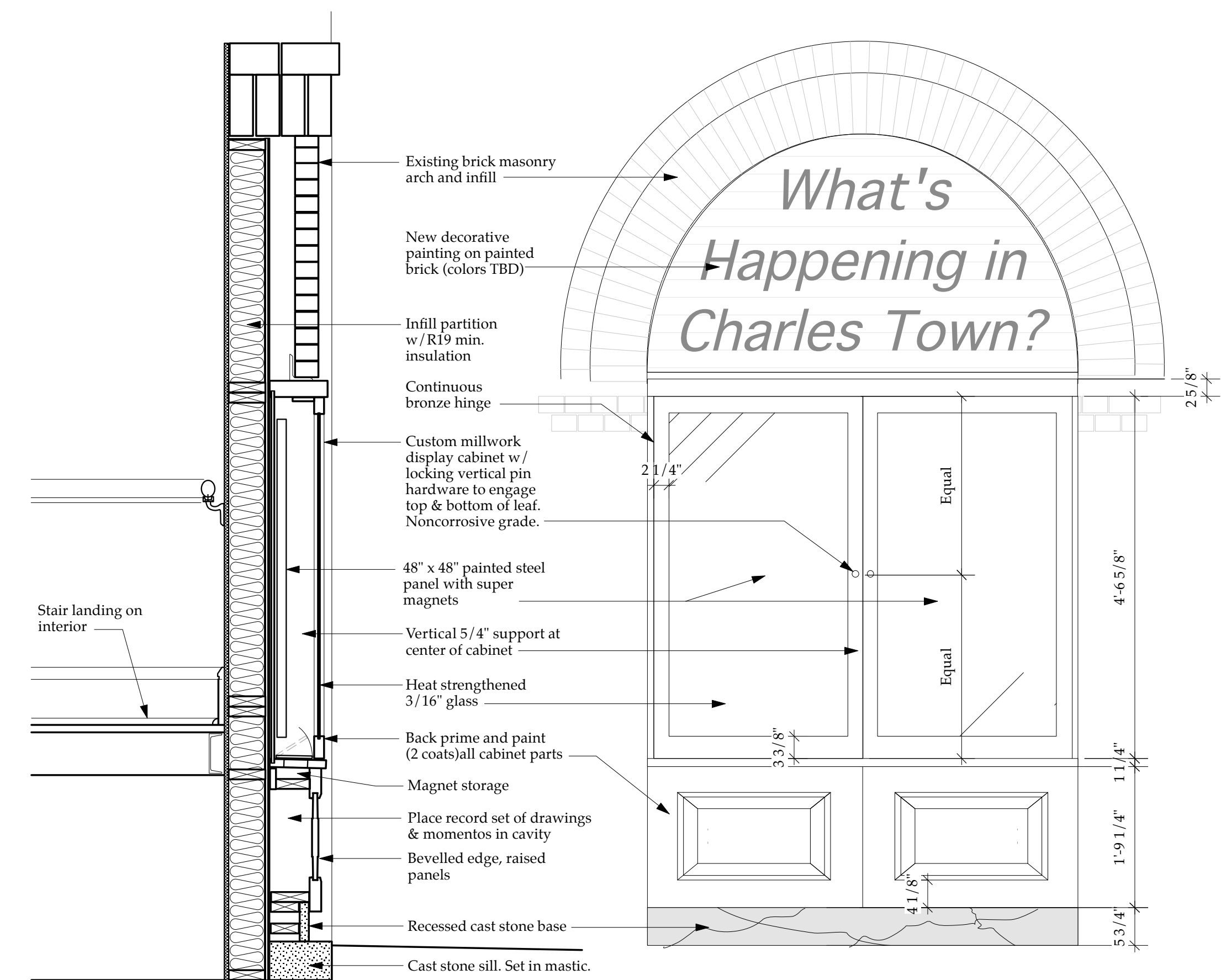

**5 Display Cabinet**  
Scale: 3/4" = 1'-0"

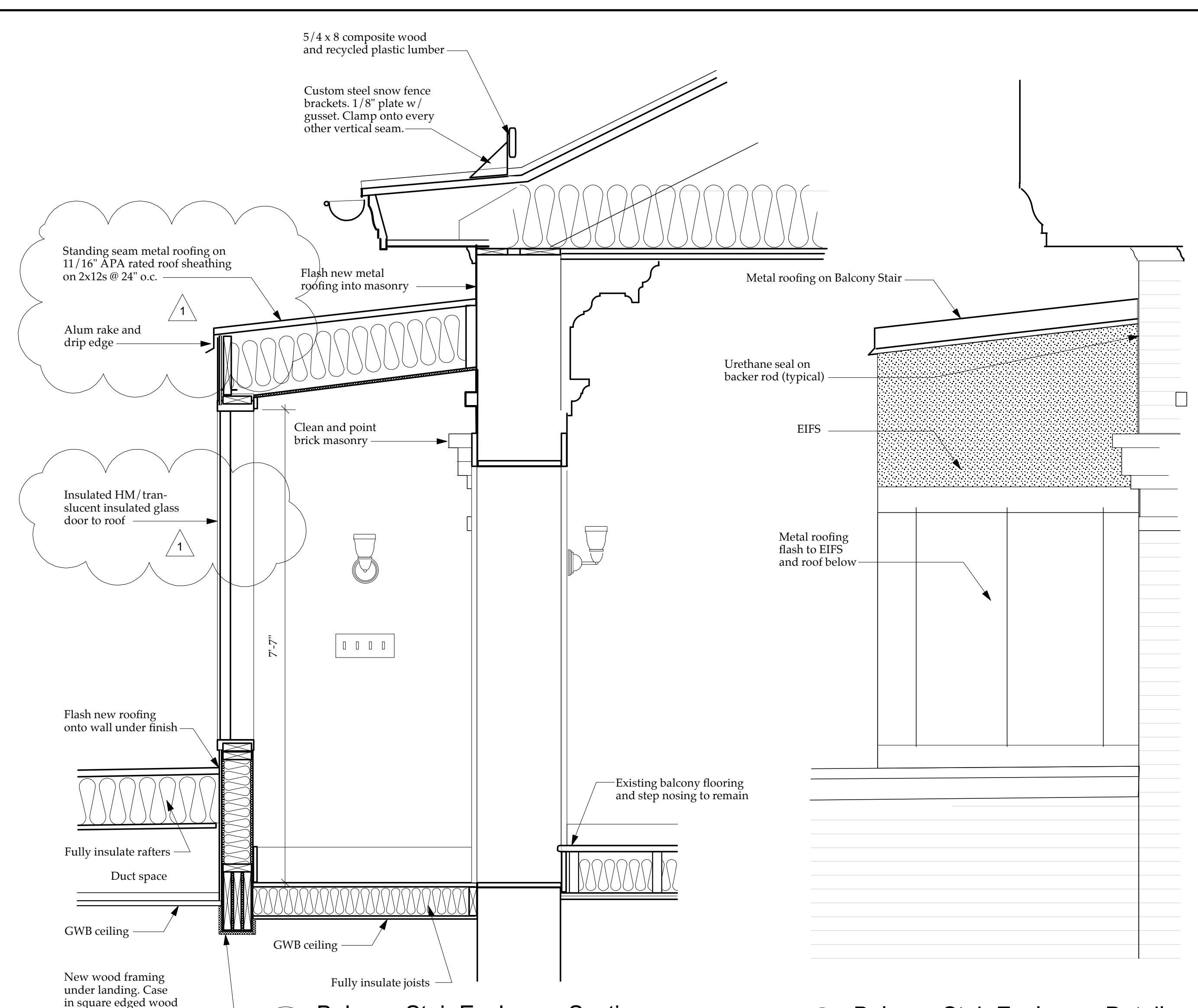

**2 Balcony Stair Enclosure Section**  
Scale: 3/4" = 1'-0"

**3 Balcony Stair Enclosure Detail**  
Scale: 3/4" = 1'-0"

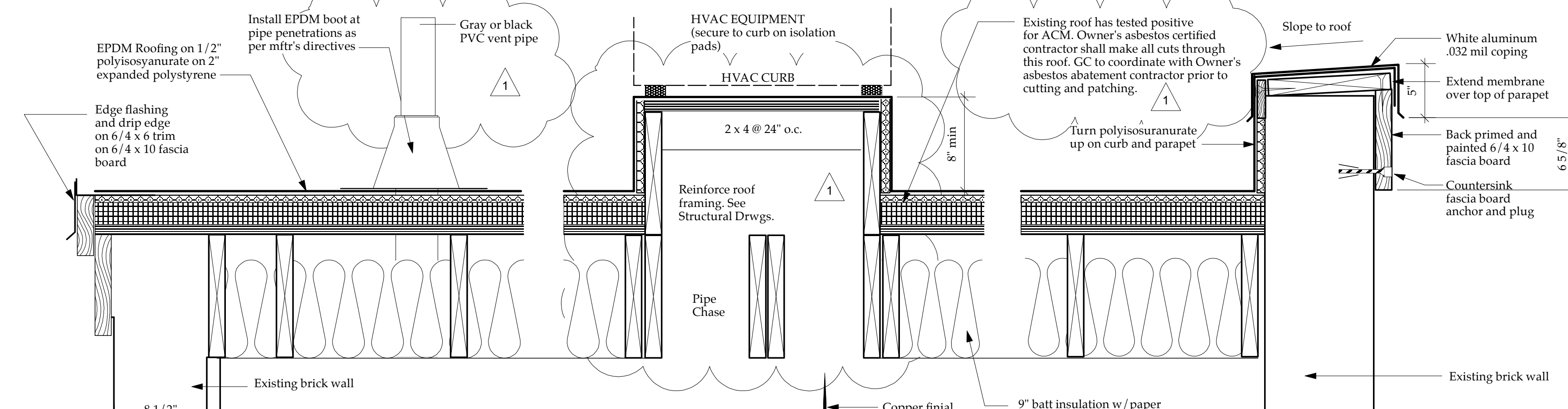

**4 East Wing Roof Details**  
Scale: 1 1/2" = 1'-0"

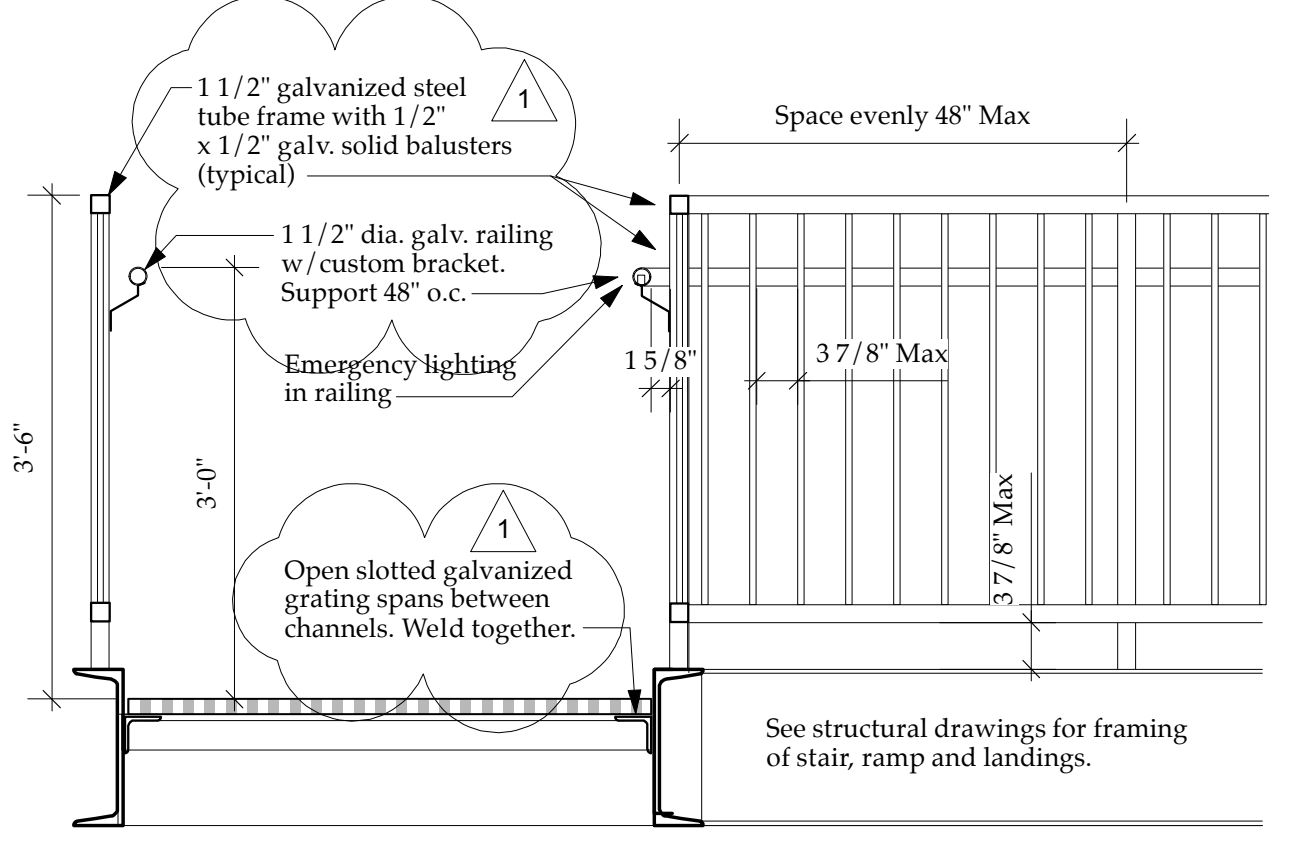

**6 Exterior Stair Detail**  
Scale: 3/4" = 1'-0"

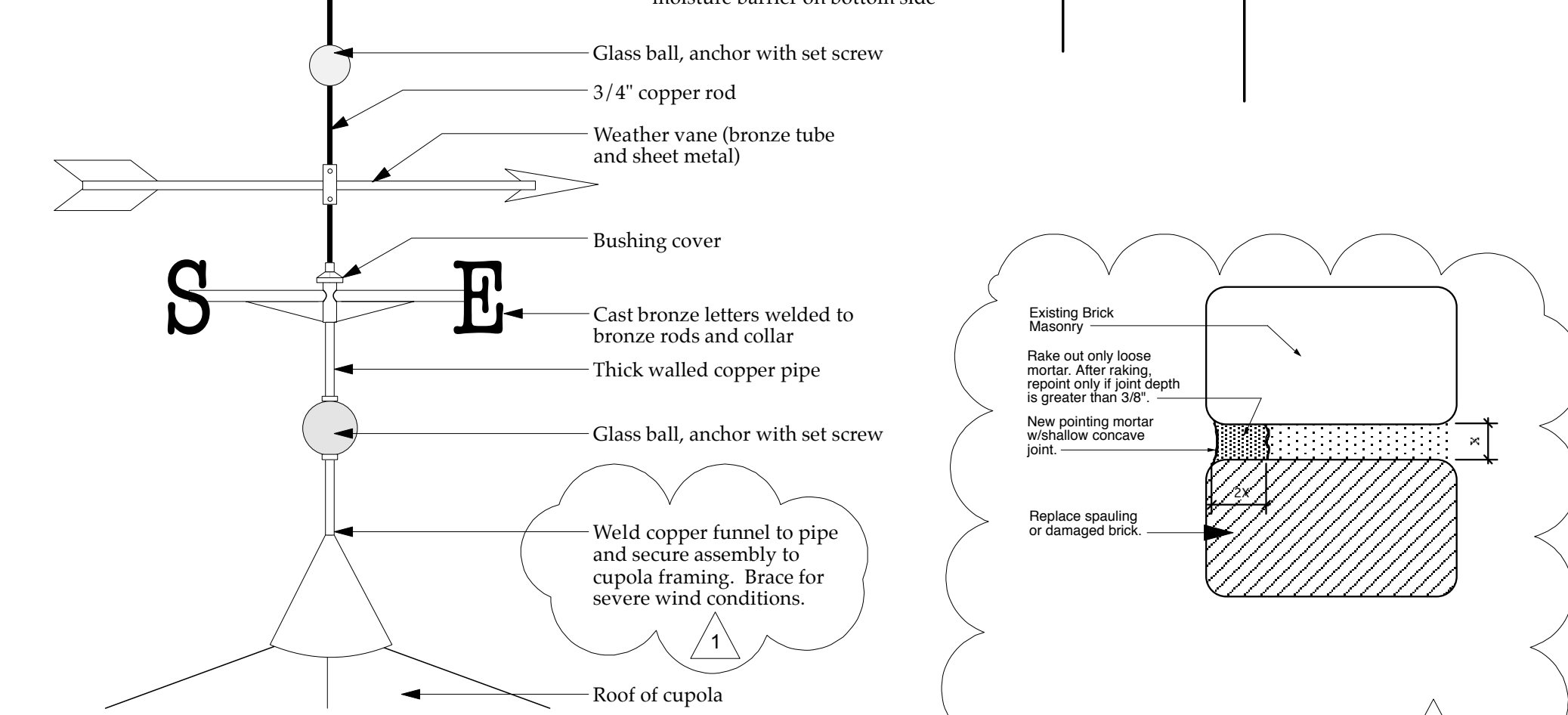

**7 Weather Vane**  
Scale: 3/4" = 1'-0"

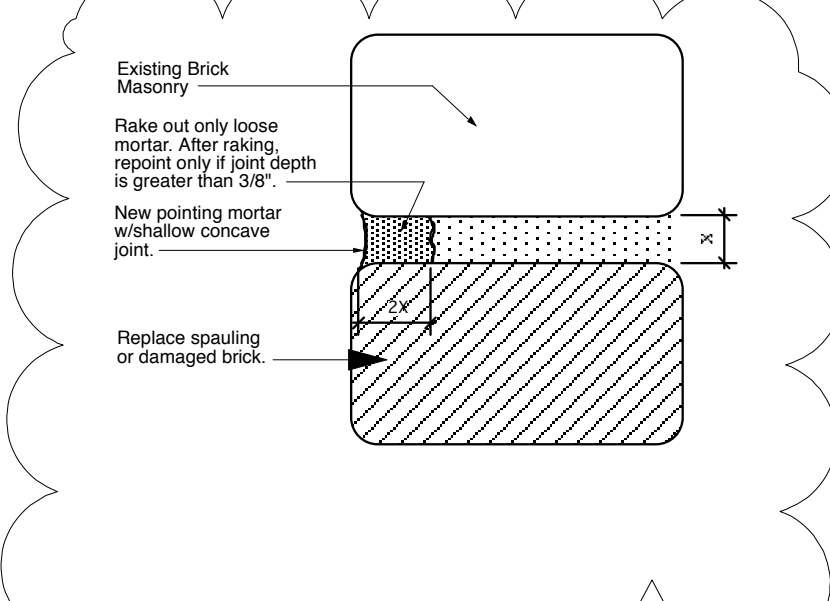

**8 Pointing Detail**  
Scale: 1 1/2" = 1'-0"

**Charles Washington Hall**  
RENOVATIONS  
Corner of George & Washington Streets  
Charles Town, W. Va.

For the  
City of Charles Town  
City of Ranson

Planning & Engineering (prime)  
**Hall Planning & Engineering, Inc**  
316 Williams Street  
Tallahassee, FL 32303

Landscape Architecture  
**Stromberg/Garrigan & Assoc., Inc.**  
102 E. Main Street - The Penn Bldg  
Somerset, PA 15501

Historic Preservation & Architecture  
**Landmarks SGA, LLC**  
102 E. Main Street - The Penn Bldg  
Somerset, PA 15501

Structural Engineer  
**R.L. Silman Associates**  
1053 31st Street NW  
Washington D.C. 20007

Mech/Elect Engineer  
**Comfort Designs**  
620 Pennsylvania Avenue  
Winchester, VA 22601

Architect  
**GROVE & DALL'OLIO**  
ARCHITECTS PLLC  
220 WEST KING • MARTINSBURG, WEST VIRGINIA • 25401

Issue/Revision Seal  
1 Bid Phase Revisions 03/04/15

Drawing Title

**Exterior Details**

Date 10/22/14  
Scale Project Number 11105  
Drawing Number

**A9.1**