

Copyright 2015: COMFORT DESIGN INC. Michael F. Howell, P.E. 3/19/2015 10:38 AM E(CWH).dwg

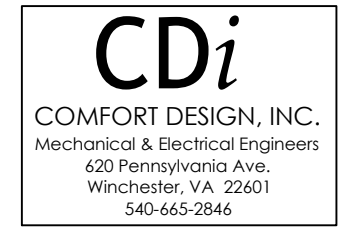

NORTH (magnetic)

Charles Washington Hall
RENOVATIONS
Corner of George & Washington Streets
Charles Town, W.Va.

For the
City of Charles Town
City of Ranson

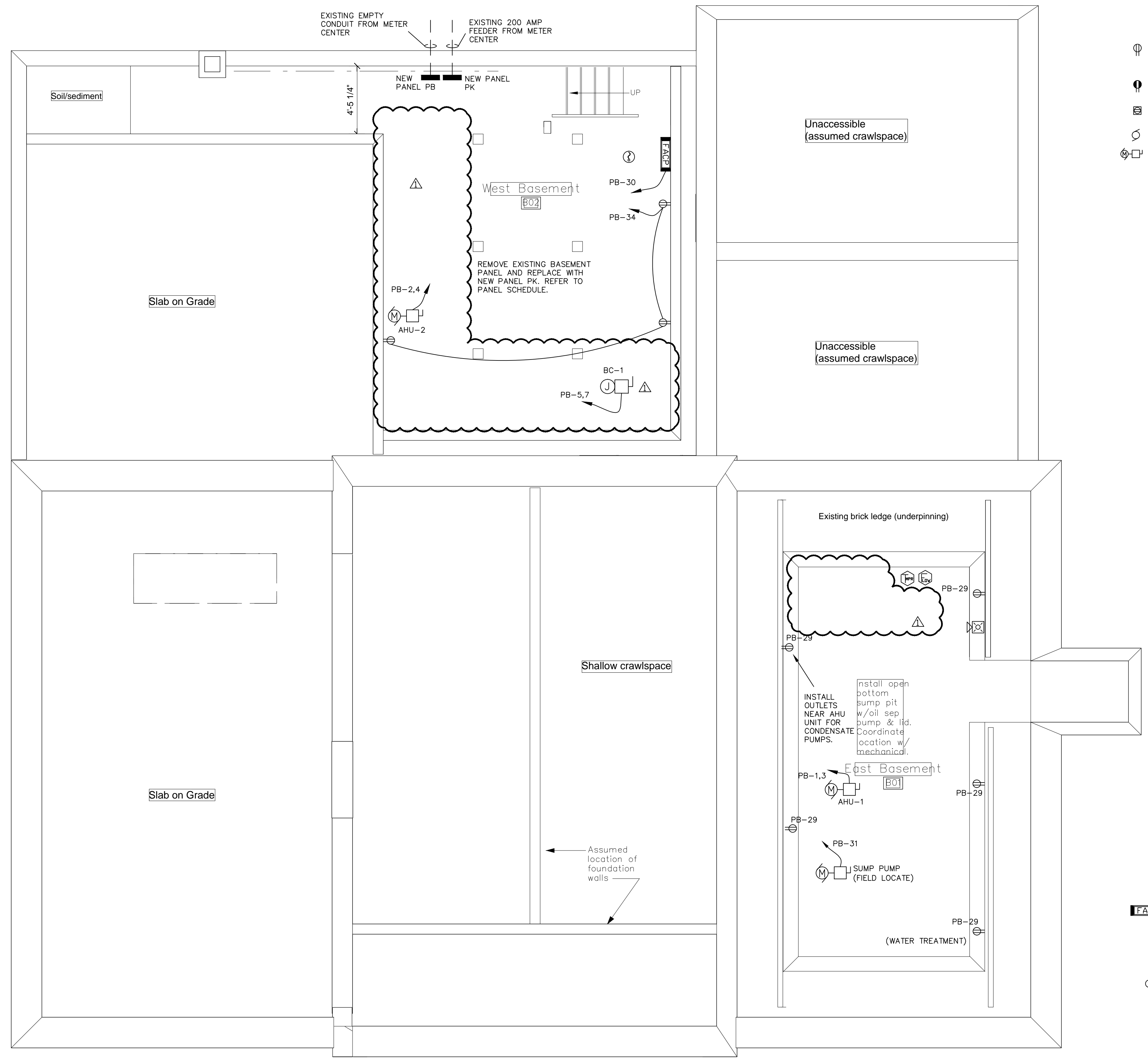

- Ⓧ DUPLEX RECEPTACLE (DEVICES AND COVERPLATES SHALL BE DARK BROWN PLASTIC.)
- Ⓧ GFCI RECEPTACLE WP DENOTES WEATHERPROOF COVER
- Ⓧ FLOOR OUTLET IN RECESSED BOX WITH FLUSH MOUNT COVERPLATE.
- Ⓧ MOTOR CONNECTION
- Ⓧ MOTOR WITH DISCONNECT SWITCH EQUIPPED WITH FUSES PER NAMEPLATE DATA.

FIRE ALARM SYMBOLS

- Ⓧ FIRE ALARM PULL STATION
- Ⓧ FIRE ALARM TAMPER SWITCH
- Ⓧ FIRE ALARM FLOW SWITCH
- Ⓧ PHOTOELECTRIC SMOKE DETECTOR
- Ⓧ KITCHEN HOOD INTERFACE
- Ⓧ FIRE ALARM CONTROL PANEL
- Ⓧ FIRE ALARM REMOTE ANNUNCIATOR
- Ⓧ FIRE ALARM STROBE
- Ⓧ FIRE ALARM HORN/STROBE
- Ⓧ MAGNETIC DOOR HOLD OPEN DEVICE

BASEMENT POWER PLAN
1
E2-1 1/4" = 1'-0"

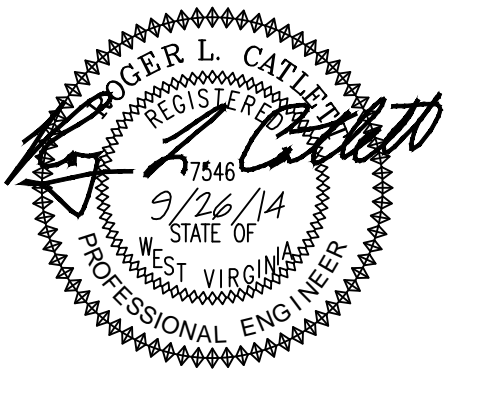

Planning & Engineering (prime)
Hall Planning & Engineering, Inc
316 Williams Street
Tallahassee, FL 32303

Landscape Architecture
Stromberg/Garrigan & Assoc., Inc.
102 E. Main Street-The Penn Bldg
Somerset, PA 15501

Historic Preservation & Architecture
Landmarks SGA, LLC
102 E. Main Street-The Penn Bldg
Somerset, PA 15501

Structural Engineer
R.L. Silman Associates
1053 31st Street NW
Washington D.C. 20007

Mech/Elect Engineer
Comfort Designs
620 Pennsylvania Avenue
Winchester, VA 22601

Architect



Issue/Revision	Seal
Δ REVISED VRF 4 MAR 2015	

Drawing Title

BASEMENT POWER PLAN

Date 9/26/14
Scale Project Number 11105
Drawing Number

E2.1